



On Show Daily, from 10am - 5pm
 Sales: info@kentgush.co.za
 Contact: 082 552 1005



Pro Shop: 010 500 0300

Bookings: golf@eyeofafrica.co.za

Events: events@eyeofafrica.co.za

Website: www.eyeofafrica.co.za

SECURE YOUR DREAM LIFESTYLE

Stands From R950 000

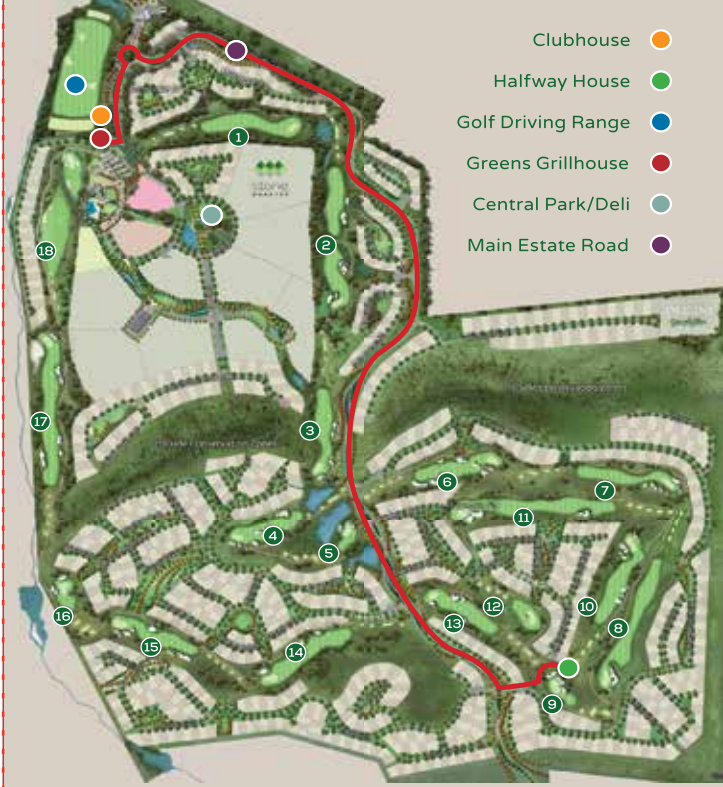

EYE OF AFRICA GOLF ESTATE
Golf Course Layout



- Clubhouse ●
- Halfway House ●
- Golf Driving Range ●
- Greens Grillhouse ●
- Central Park/Deli ●
- Main Estate Road ●



SIGNATURE GREG NORMAN DESIGN

Golf Course Scorecard

COMPETITION		H/I	C/H
PLAYER A			
PLAYER B			
PLAYER C			
PLAYER D			

HOLE	1	2	3	4	5	6	7	8	9	OUT
BLACK	395	574	427	337	214	370	430	581	210	3538
YELLOW	386	540	396	337	194	370	408	543	210	3384
WHITE	343	503	360	291	155	333	408	498	166	3057
BLUE	343	459	319	253	126	271	339	464	156	2730
RED	303	431	279	214	92	263	307	433	117	2439
PAR	4	5	4	4	3	4	4	5	3	36
STROKE	16	6	8	12	14	4	2	10	18	
A SCORE										
RESULT										
B SCORE										
RESULT										
RESULT A + B										
C SCORE										
RESULT										
D SCORE										
RESULT										
RESULT C + D										
ALLIANCE										

All distances on the tee are measured to the middle of the green

DATE:	TIME:	HOLE:	RESULT
PLAYERS SIGNATURE			
MARKERS SIGNATURE			

10	11	12	13	14	15	16	17	18	IN	OUT	TOT	C/H	NET
396	606	180	371	445	419	192	567	496	3672	3538	7210		
381	594	180	347	408	374	170	567	462	3483	3384	6867		
381	551	144	311	408	334	153	524	403	3209	3057	6266		
345	493	118	276	370	294	113	483	363	2855	2690	5545		
301	466	95	248	325	266	113	459	335	2608	2439	5047		
4	5	3	4	4	4	3	5	4	36	36	72		
1	9	17	13	3	11	15	7	5					

Distance markers on the fairways are measured to the front of the green

EYE OF AFRICA LOCAL RULES

1. READY GOLF

Eye of Africa implements the Ready Golf Rule

2. OUT OF BOUNDS

(a) Beyond any line of white stakes. (b) All residential properties, present and future, are private and out of bounds. No golf balls may be retrieved, even if they are visible. (c) Beyond any of the estate's boundary walls

3. LATERAL HAZARD

All bush to be treated as lateral hazard.

4. ROADS AND PATHS

A ball coming to rest on a defined or artificially surfaced roadway may be lifted and dropped within one club length from the nearest point of relief, not nearer the hole.

5. FLOWER BEDS

All flower beds are to be treated as G.U.R. and relief is compulsory, within one club length from the nearest point of relief, not nearer the hole.

6. IMMOVABLE OBSTRUCTIONS

All distance markers, sprinkler heads, control boxes, rain shelters, benches, dustbins, sand holders, wooden fencing, drinking fountains and other fixtures being part of the irrigation system are to be treated as immovable obstructions. Relief may be obtained under rule 24-2b.

7. LIGHTNING PROCEDURE

Notice to discontinue play due to lightning will be announced by a long continuous blast of the siren at which stage all persons must return to the Clubhouse. Two repeated short blasts will announce resumption of play. Even in the absence of sirens, a player is the sole judge as to the need to suspend play when lightning is visible. Rain shelters are intended to provide shelters from rainfall only and are not designed nor intended to provide protection in the event of lightning strikes.

8. PLACING

One club length not nearer the hole.

• REPLACE DIVOTS • REPAIR PITCH MARKS • AVOID SLOW PLAY

+ HANDICAPS

+1 Hole 8
+2 Hole 11
+3 Hole 17

MEN	COURSE RATING	SLOPE RATING	LADIES	COURSE RATING	SLOPE RATING
BLACK	77,3	143			
YELLOW	75,3	139			
WHITE	72,0	132			
BLUE	68,4	124	BLUE	74,3	140
RED	65,4	114	RED	70,5	132